

## Software Version : EasyBuilder Pro V6.06.02.308

### Corrections

The following issue in V6.06.02.301 was addressed in this release:

1. Customized file handling setting of Trend Display cannot be saved.

### Communication and Drivers

1. **[MODBUS RTU, RTU over TCP]**

**[MODBUS ASCII]**

**[MODBUS TCP/IP]**

0x/1x address range limit setting supports csv file import/ export.

## Software Version : EasyBuilder Pro V6.06.02.301

### Corrections

The following issues were addressed in this release:

1. The count parameter for statistics related macro functions (AVERAGE, MAX, MIN...etc) cannot be greater than 263.
2. Scientific notation with negative exponent cannot be used in macro.
3. In [Action Trigger], the actions are not triggered in accordance with the Value change mode setting.
4. In picture library setting, slight color deviation may be observed in the preview image within the edit window.

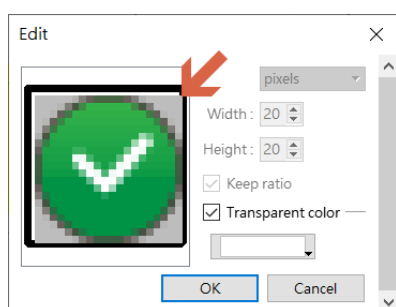

5. ID:1 error may occur on selected devices.
6. In [JS object], using canvas transform yields unexpected results.
7. In [Numeric] and [ASCII], using particular text alignment or position settings can stretch the touchable area beyond the object's bounds.

### Communication and Drivers

1. **[Siemens S7-1200/S7-1500 Absolute Addressing (Ethernet)]**  
Added support for 64-bit addresses: IL, QL, ML.
2. **[Rockwell EtherNet/IP (CompactLogix) – Free Tag Names]**  
**[Rockwell EtherNet/IP (ControlLogix) – Free Tag Names]**  
Index registers can now be used in multi-dimensional arrays.
3. **[KEYENCE KV-8000 (Symbolic) (Ethernet)]**  
Fixed the issue where bit array data is not correctly displayed.

4. **[Schneider SoMachine M Series (Ethernet)]**  
**[CODESYS V3 (Ethernet)]**

Added support for data types: LTIME, DATE, TIME\_OF\_DAY (TOD), DATE\_AND\_TIME (DT).

## Software Version : EasyBuilder Pro V6.06.02.259

### Corrections

The following issues were addressed in this release:

1. Importing Excel file data to the Label Tag Library yields incorrect result.
2. 2D Barcode Display object cannot be created after editing of any Weincloud or Push Notification Barcode Display object.
3. ID:4 error may occur on selected devices.
4. Projects in which KEYENCE KV-8000(Symbolic) driver is used cannot be opened.

### Communication and Drivers

1. **[OMRON EtherNet/IP NJ/NX Series]**  
Fixed the issue where HMI-device communication does not resume after online editing.
2. **[Free Protocol]**  
Added support for pass-through.
3. **[Rockwell CompactLogix – Free Tag Names]**  
Increased the allowed length of tag names to 256.

## Software Version : EasyBuilder Pro V6.06.02.233

### *New Supported Model*

cMT2166X

### *Corrections*

The following issues were addressed in this release:

1. When Data Sampling saves to HMI memory until space full in Customized File Handling mode, it incorrectly saves to system reserved memory when storage space is insufficient. Following the correction, data sampling will stop in such a case.
2. Macro's Round() function does not work properly on non-cMT models such as iE, eMT series.
3. Data for an hour may be missing when reading a db file using EasyConverter.
4. The system register LB-11958 is not triggered when time settings are incorrect.
5. The system keyboard setting of a Numerical Input object cannot be saved without at least a custom keyboard set up.

### *Communication and Drivers*

1. **[Siemens S7-1200/S7-1500 Absolute Addressing (Ethernet)]**  
Fixed errors that occur when reading consecutive string data.
2. **[CODESYS V3 (Ethernet)]**  
Fixed communication issues for iE, eMT (non-cMT) models.
3. **[CODESYS V3 (Ethernet)] [Schneider SoMachine M Series (Ethernet)]**  
Added an option for login to device using username and password.
4. **[FATEK FB/FBs/B1/B1z Series]**  
Added address types: WX\_16BIT, WY\_16BIT, WM\_16BIT, WS\_16BIT.
5. **[KEYENCE KV-8000 (Symbolic) (Ethernet)]**  
Fixed communication issues with tags that are mapped to W, DM (DD.ddd format) addresses.

## Software Version : EasyBuilder Pro V6.06.02.190

### New Supported Model

cMT2108X2

### New Features

#### EasyBuilder Pro

##### 1. [Find/Replace]

Added the possibility to find in currently selected objects.

##### 2. [System Registers]

Added EasyAccess 2.0 related system registers for displaying the number of connected users and their usernames.

#### cMT/cMT X Models

##### 3. [Condition]

Condition object is now available. It provides a GUI way to build condition, which may be used in place of macro commands.

##### 4. [Trend Display]

a. Added [Connect data gaps] option. This option decides whether the trend curves stay connected when there are missing data. Below are two trend curves drawn from the same data source; one is not connected and the other is connected.

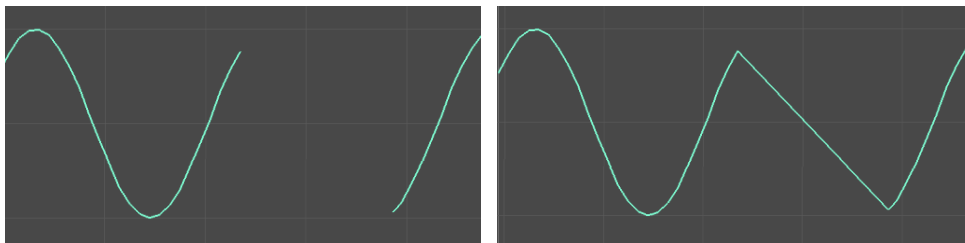

b. Added "Zoom button visibility" setting. It provides an option to show/hide the Zoom

Button. 

c. Scrolling along only the X-axis or Y-axis is now possible.

d. Displaying the range where there are originally more than 10000 records is now possible. Following this release, when the number of records exceeds 10000 within the specified time range, data from the entire range will still be displayed. However, selected data points may be omitted in order to maintain system performance. (Before, the display limit was strictly the last 10000 records within specified time range.)

### 5. [Energy Demand]

Added a control address for clearing and resetting all relevant data.

### 6. [Action Trigger]

Added [User secure access] mode. In this mode, actions are triggered when access to a security class is obtained or lost.

### 7. [Recipe View]

Added [Allow in-cell editing] option for editing recipe records directly in a Recipe View table.

Below is an example:

| Menu          | Filter |        |       |
|---------------|--------|--------|-------|
| Item          | Small  | Medium | Large |
| Vanilla Latte | 5.00   | 6.00   | 7.00  |
| Mattya        | 4.20   | 5.20   | 6.20  |
| Fruit Tea     | 4.00   | 5.00   | 6.00  |
| Latte         | 3.80   | 4.80   | 5.80  |
| Cappuccino    | 3.50   | 4.50   | 5.50  |
| Black Coffee  | 3.00   | 4.00   | 5.00  |

| Cart |   |   |   |   |   |  |  |  |  |
|------|---|---|---|---|---|--|--|--|--|
| A    | B | 7 | 8 | 9 | ← |  |  |  |  |
| C    | D | 4 | 5 | 6 | ← |  |  |  |  |
| E    | F | 1 | 2 | 3 | ← |  |  |  |  |
|      |   | . | 0 | - | ← |  |  |  |  |

### 8. [Operation Log]

A label from the label library can now be used as comment.

### 9. [Screen Hardcopy]

Added [Crop window] option for taking a cropped screenshot.

### 10. [Backup][Import/Export]

Semicolon (;) can now be used as delimiter in a CSV file. Related settings can be found in [System Parameters].

### 11. [Draw]

Link Line now allows arrowheads at the ends.

### 12. [Data Sampling] [Event Log]

Added support for using Backup object to generate a backup file with checksum. EasyConverter can then be used to examine data integrity.

### 13. [JS Object]

Canvas now supports getImageData method.

#### 14. [Database Server]

MS SQL now supports Numeric(p,s) data types.

#### 15. [PDF Reader] [Picture View]

Two-finger zoom in/out gestures are now supported on capacitive touchscreens.

#### 16. [Video In]

IP Camera video streams can now be displayed in cMT Viewer on Windows.

#### 17. [Trend Display, Event Display, and objects that contain Option dialog]

The language used in Option dialog can now be changed according to the language mode system register.

### Communication and Drivers

#### 1. [CODESYS V3 (Ethernet)] [Weintek Built-in CODESYS]

##### [Schneider SoMachine M Series (Ethernet)]

Index registers can now be used in multi-dimensional arrays.

#### 2. [MODBUS TCP/IP][MODBUS RTU, RTU over TCP]

Increased the number of special-purpose 0x, 1x addresses (0x\_1, 0x\_2,..., 1x\_1, 1x\_2,...) to 32 each.

#### 3. [DELTA AS300/DVP-ES3 MODBUS RTU/ASCII] [DELTA AS300/DVP-ES3 MODBUS TCP/IP]

These drivers now support DVP-ES3 and are renamed accordingly. Also added addresses: X(Oct), Y(Oct), X\_Bit(Oct), Y\_Bit(Oct)