

1 Installation and Startup Guide

This document covers the installation of cMT3071/3072 Series HMI, for the detailed specifications and operation, please refer to Datasheet, Brochure and EasyBuilder Pro User Manual. Please read all warnings, precautions, and instructions on the device carefully before use.

Install Environment:

NEMA Rating	The HMI product is UL type 4X (NEMA Type 4X) indoor use only.
Electrical Environment	The HMI product has been tested to conform to European CE requirements. This means that the circuitry is designed to resist the effects of electrical noise. This does not guarantee noise immunity in severe cases. Proper wire routing and grounding will insure proper operation.
Environmental Considerations	<ol style="list-style-type: none"> (1) Make sure that the displays are installed correctly and that the operating limits are followed. Avoid installing units in environments where severe mechanical vibration or shocks are present. (2) Do not operate the unit in areas subject to explosion hazards due to flammable gases, vapors or dusts. (3) Do not install the unit where acid gas, such as SO₂ exists. (4) This device should be mounted in the vertical position and for use on the flat surface enclosure. (5) Conform to UL 61010-2-201 safety requirement for use in Pollution Degree 2 Environment and dry location. (6) Relative Humidity: 10% ~ 90% (non-condensing)
Cleaning Considerations	Clean the device using dry cloths. Do not use liquid or spray detergents for cleaning.
IP rating	IP 65
 Warning	Protection impairment if used in a manner not specified by the manufacturer. Déficit de protection si utilisé d'une manière non spécifiée par le fabricant.

2 Unpacking the Unit

Unpack and check the delivery. If damage is found, please contact the supplier.

NOTE: Place the operator panel on a stable surface during installation. Dropping it or letting it fall may cause damage.

The package includes:

(1) Installation Instruction, 2-sided A4 *1 (2) Human Machine Interface *1 (3) Power Connector *1 (4) Brackets & Screws *1 pack (5) Fuse 3.15A/250V 5*20mm *1 (6) USB Stick Clamp & Tying Strap *1

USB Stick Clamp Usage

Combining the USB Stick with the clamp and the tying strap can prevent USB stick from disconnecting with HMI when strong vibration is present.

1. Insert the USB connector to the clamp and tie them together with the tying strap.
2. Press the spring and insert the USB stick into HMI.

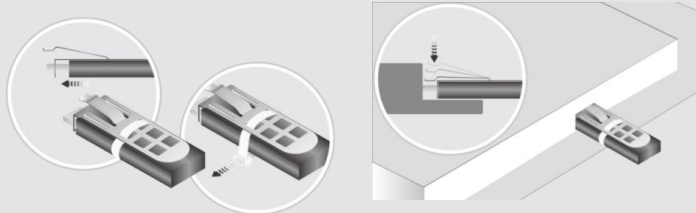

3 Installation Instructions

Use a control box that provides enough space for the operator panel in position, using all the provided brackets and screws. Plan for adequate space around the enclosure, for ventilation and cables. Preventing the panel from being deformed by heat from other devices inside the enclosure. Minimum required clearances (along top / Bottom / Sides 15 mm. Maximum panel thickness: 4.5 mm. The aluminum flat-sheet at the back of the sink since its heat can rise to 70°C in between the back of the unit and other

4 Power Connections

 Power Connector Specifications:
Wire AWG: 24-12
Wiring Conductor Minimum Temperature: 0°C
Screw Torque: 4.5 lbf-in (max.)
Copper conduct only.

NOTE:

1. Connect positive DC line to the '+' terminal.
2. When downloading project using EasyBuilder Pro with PLC and PC simultaneously, it may result in damage to HMI or PC.

5 System Settings

When HMI is powered up and displays the Start Button in the upper-left corner. Tap the Start Button to open the Setting dialog box. (Default System Password: 111111). Go to the Network tab, and setup your network settings. In Setting dialog box you can see device settings, you can configure general settings, set HMI Time and Language, etc. (Please refer to EasyBuilder Pro User Manual for more details.)

6 EasyBuilder Pro Software

Launch EasyBuilder Pro software, select the project file, press F7 shortcut key to open the download dialog box. Click Download to download this project. Using screensaver and backlight save settings by displaying the same image on HMI. (Please refer to EasyBuilder Pro User Manual for more details.)

7 Communication Connections

NOTE:

1. COM2 and COM3 [RS485] 2W support MPI 187.5K, please use one at a time.
2. Only Tx & Rx (no RTS/CTS) may be used for COM1 RS232 when COM3 RS-232 is also used.

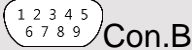

Con.B

COM1/COM3 [RS232] 9 Pin, Male, D-sub

PIN#	COM1 [RS232]	COM3 [RS232]
1		
2	RxD	
3	TxD	
4		
5	GND	
6		
7	RTS	TxD
8	CTS	RxD
9		

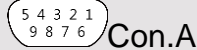

Con.A

COM2/COM3 [RS485]/CAN Bus 9 Pin, Female, D-sub

PIN#	COM2 [RS485]2W	COM2 [RS485]4W	COM3 [RS485]2W	CAN Bus
1	Data-	Rx-		
2	Data+	Rx+		
3		Tx-		
4		Tx+		
5	GND			
6			Data-	
7				CAN_L
8				CAN_H
9			Data+	

8 Touchscreen Calibration & Restore Factory Default

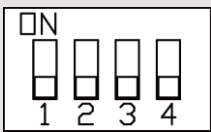

SW1	SW2	SW3	SW4	Mode
ON	OFF	OFF	OFF	Touch Screen Calibration Mode & Reset HMI to Default
OFF	ON	OFF	OFF	Hide Start Button
OFF	OFF	ON	OFF	Boot Loader Mode
OFF	OFF	OFF	ON	Reserved
OFF	OFF	OFF	OFF	Normal

Restore Factory Default:

Apart from flipping DIP SW 1 to ON position, restoring factory default can be carried out by following Step 5 to open the Setting dialog box. Go to Reset Options tab and press the button of "Reset HMI to default". Please note that the projects and data stored in the unit are all cleared after pressing this button.

Another way to enter touch screen calibration mode: Press and hold anywhere on the screen for more than 2 seconds when HMI starts.

9 Battery Replacement

Battery Specification: UL Certification Battery, Type CR2032, Rated 3V, Max. Abnormal Charging Current 10mA, Working Temperature: max. 80°C

Battery replacement shall be performed by qualified personnel (engineer) only and care must be taken when handling lithium batteries. For more information on battery replacement and disposal considerations, please refer to the following link:

http://www.weintek.com/download/MT8000/eng/FAQ/FAQ_103_Replace_Battery_en.pdf

CAUTION

Power

NOTE: Make s
installing the un

Use power output th
powered by DC pow
systems. The power
supply. The peak sta

Fusing Require-
ments

Fuse rating: 3.15A/2
seconds of power up
DC power is incorre
fuse shall be perform
<http://www.weintek.c>

High Voltage

An Internal fuse will
voltage sources sho

Emergency Stop

A Hard-wired EMER
ICS Safety Recomm

Supply Voltage
Condition

Do not power the un
power supply. Note:
current to power the

Wire Routing

- a. Power wire leng
 - b. Please use twist
 - c. If wiring is to be
 - d. Keep AC, high e
 - e. Add a resistor an
- supply and the fr
dissipation. Typi

DANGER

Hardware
Considerations

The system design
thereby create an
interface can lead
physical injury to the
If you use any prog
potential safety haza
steps depend on y
installation of solid-
installation of Contro

Programming
Considerations

To conform to ICS
ensure that all writ
checks built into the
personnel.

Limited Warranty

This product is limited warranted ag
The proven defective product will e
This warranty shall not cover any p
(a) Out of warranty period which is 12 month
(b) Damage caused by Force Majeure, acci
(c) Product has been repaired or taken apar
(d) Products whose identification markings f